

FRANSYL

IZOLEED SYSTEM

PRO LEED SINGLE LAYER ROOFING SYSTEM

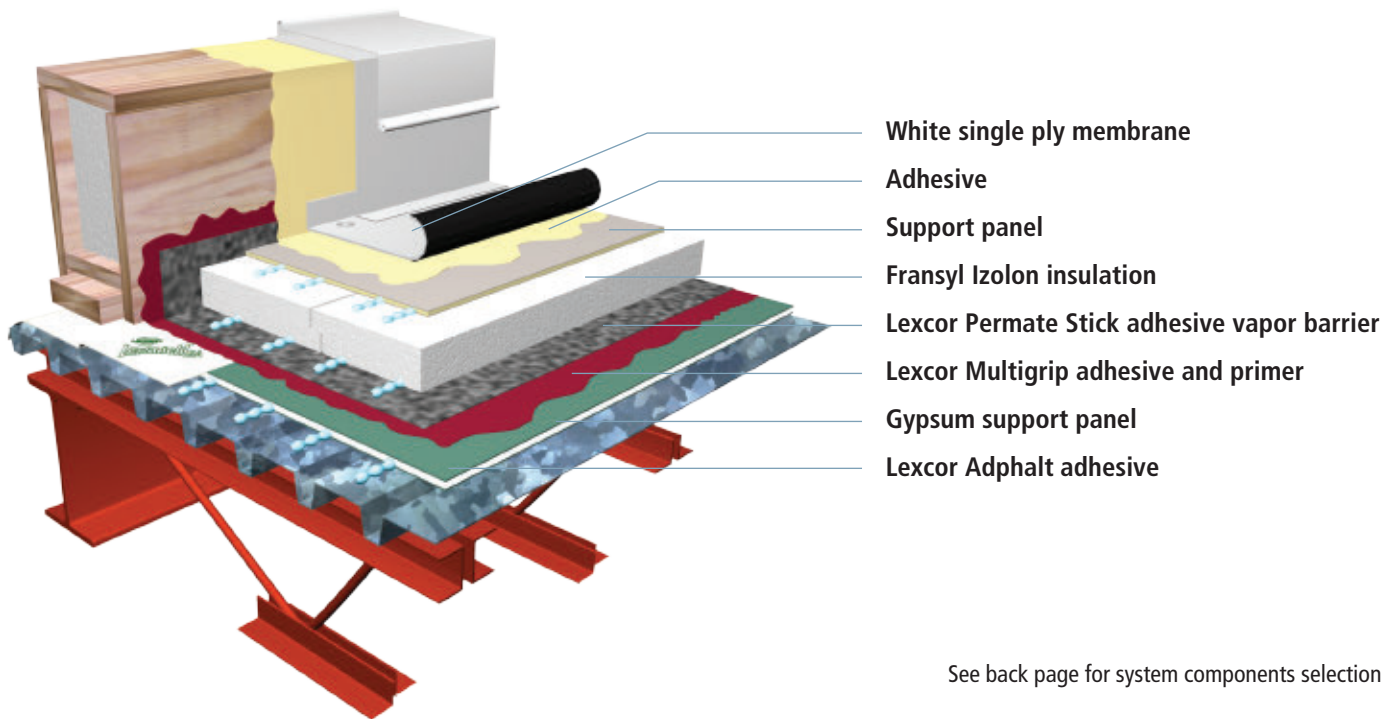

- White single ply membrane
- Adhesive
- Support panel
- Fransyl Izolon insulation
- Lexcor Permaste Stick adhesive vapor barrier
- Lexcor Multigrip adhesive and primer
- Gypsum support panel
- Lexcor Adphalt adhesive

See back page for system components selection

ADVANTAGES

- Materials and workmanship warranty available with this system*
- Insulation thermal value warranty of minimum 35 years
- No asphalt adhesive
- Flameless
- Odor free
- VOC free
- Easy installation
- Load weight reduction
- Achieves Novoclimat insulation levels
- Contributes to LEED score
 - Membrane reflectivity
 - Fransyl Izoflûte insulation recyclability
 - Percentage of recycled materials in Fransyl's Izoflûte insulation
 - Local manufacturing of Fransyl's Izoflûte insulation

ACKNOWLEDGMENT*



*according to selected components

*Some conditions apply

T. 450.477.4423

1.800.363.2307

FRANSYL.COM

IZOLEED SYSTEM

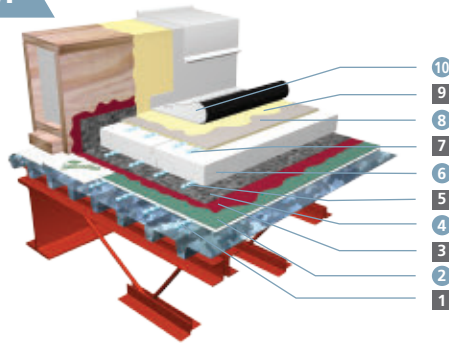

Date: _____

Project's name: _____

Address: _____

Deck: wood concrete steel other: _____

Building: Area(roof): _____ ft²

Height / number of stage(s): _____

IZOLEED SYSTEM MATERIAL OPTION

Composition down to up	Attachment/Adhesion	Material
Support panel	1 <input type="checkbox"/> Lexcor Adphalt adhesive <input type="checkbox"/> Mechanical fasteners (screws and plates)	2 <input type="checkbox"/> Gypsum _____ in <input type="checkbox"/> Cement board _____ in <input type="checkbox"/> Siliconed gypsum _____ in <input type="checkbox"/> Siliconed and primed gypsum _____ in
Vapor barrier	3 <input type="checkbox"/> Lexcor Adphalt adhesive <input type="checkbox"/> Lexcor Multigrip adhesive and primer	4 <input type="checkbox"/> Lexcor Permате <input type="checkbox"/> Lexcor Permате Ultra-R <input type="checkbox"/> Lexcor Permате Stick
Flat insulation	5 <input type="checkbox"/> Lexcor Adphalt adhesive	6 <input type="checkbox"/> Fransyl Izolon insulation _____ in
<i>Optional:</i> Slope insulation	<input type="checkbox"/> Lexcor Adphalt adhesive	<input type="checkbox"/> Fransyl slope insulation (ex.: Bizolon) _____ in
Support panel	7 <input type="checkbox"/> Lexcor Adphalt adhesive <input type="checkbox"/> Mechanical fasteners (screws and plates)	8 <input type="checkbox"/> Siliconed and primed gypsum _____ in <input type="checkbox"/> HD wood fibre coated panel _____ in <input type="checkbox"/> Composite panel laminated to two fire retardant slipsheets _____ in
Cap sheet	9 <input type="checkbox"/> Water based adhesive <input type="checkbox"/> Urethane based adhesive	10 <input type="checkbox"/> White reinforced or fleece backed TPO (45 or 60) <input type="checkbox"/> White PVC <input type="checkbox"/> White EPDM (45 or 60)

Any system must be pre-approved by Fransyl Ltd. Any deviation from this system without Fransyl's authorization will automatically void the warranty in force for the system.
 Note: Fransyl reserves the right to alter without notice the composition and conditions of use of systems and materials.

To obtain a quote for the composition of the system chosen above and the information below, send this document at infodevis@fransyl.com

Load weight by ft² R-Value Budget price by ft² Note(s)