

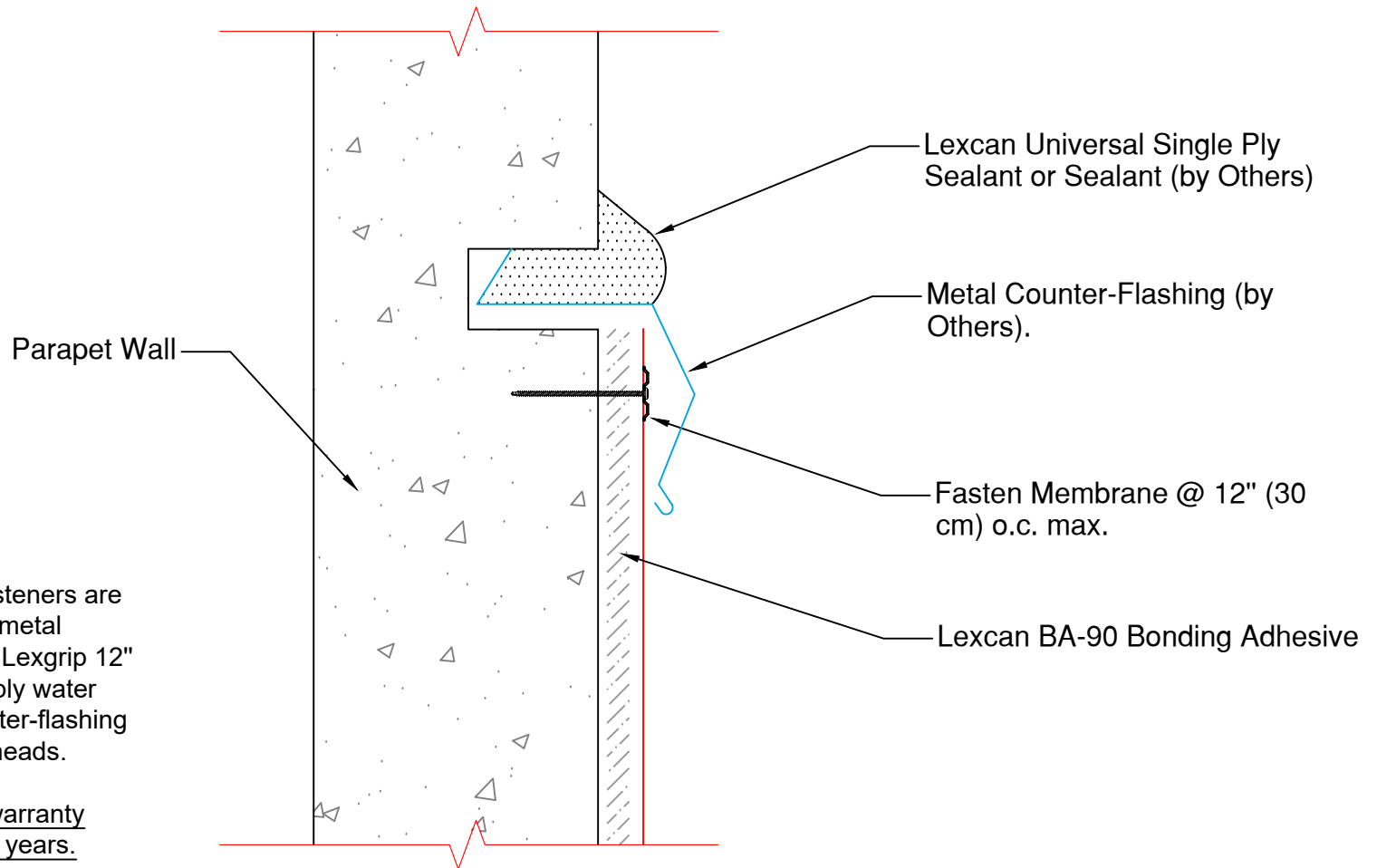

Comments: All Flashing must be a minimum 200 mm (8") above roof level and extend above roof flood level.

Masonry surfaces must be fully cured (minimum 28 days) to facilitate proper bonding.



Notes:

When mechanical fasteners are used to penetrate the metal counter-flashing, use Lexgrip 12" flat plate washers, apply water cut-off under the counter-flashing or caulk the fastener heads.

Detail not for use on warranty projects exceeding 10 years.



Mid-Parapet Termination - 1 (Reglet)  
ROOFING SYSTEMS DETAIL

Scale:
Date: 12/01/2024
Detail no.: H-S-211